



**Don't let low pressure**  
raise your blood pressure

**AquaBox System**  
Stored and pressurised water



AquaBox ❖ TECHNOLOGY  
ESPA INNOVATION

AquaBox

Collects

Stores

Pressurizes

ESPA **AquaBox** consists of a totally automatic pressure equipment with dry running protection which, in conjunction with a reserve tank, pressurises any facility in which the pressure/flow of the public network is insufficient. This equipment is suitable for both commercial and domestic use, and complies with all the applicable standards.

**AquaBox** is usually installed for the purpose of pressurising facilities or homes, and can also be installed when the pressure and/or flow of the potable water supply network is insufficient.

**AquaBox** comprises a storage tank with a potable water inlet that is controlled by a mechanical valve, a discharge outlet, a submersible or surface-operating pump, an automatic pressurising kit and a small expansion vessel.

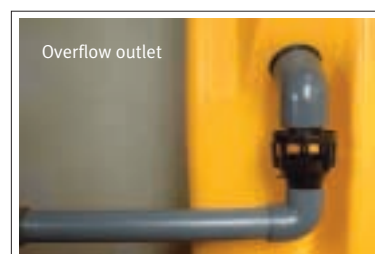

# AquaBox ❖❖❖ INSTALLATION

## SUPER COMPACT, EXTREMELY EASY



Due to its compact design, simple structure, proportioned weight and dimensions, AquaBox is extremely easy to install, thus minimising masonry work and saving in installation costs.

It is completely safe in situations of water supply cuts or misfunctions, as it has an expansion vessel, control kit with leds indicating the voltage, pump in operation, breakdown and reset push buttons.

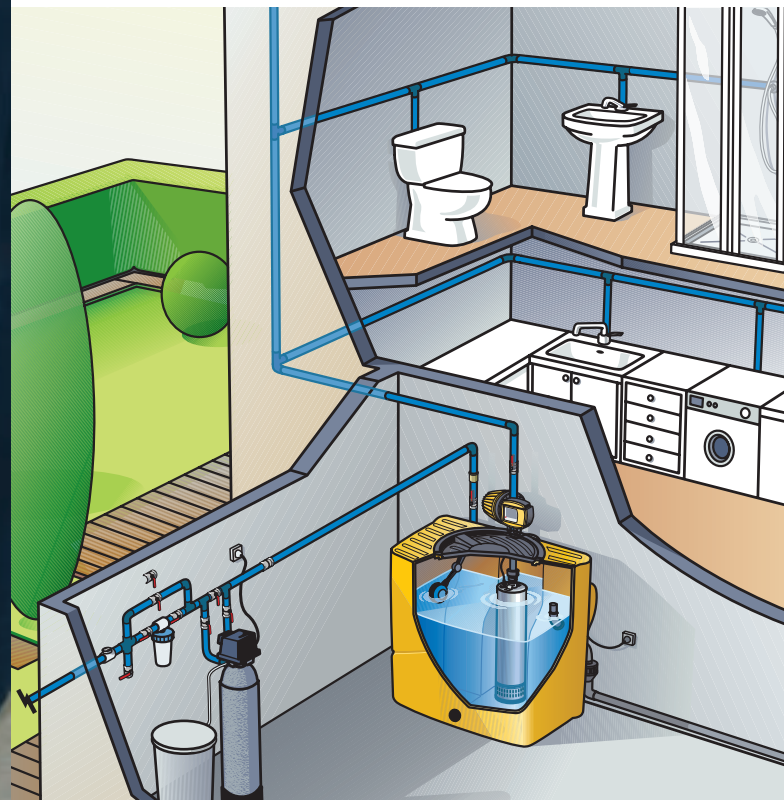

### Dimensions and weights

AquaBox with Pump	Weights table		Capacity (Litres)	Maximum height (mm)
	Empty (Kg)	Full of water (Kg)		
Acuaría 07 4M / 5M	32,5	212	180	930
Tecnopres 15 4M / 5M	30,5	210	180	966
Prisma 15 4M	31,5	211	180	1020

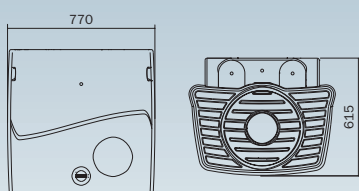

The tank has an overflow outlet which helps to prevent the potable water from the public water supply becoming polluted in the event of refluxes and in compliance with the EN 1717 European quality standard.

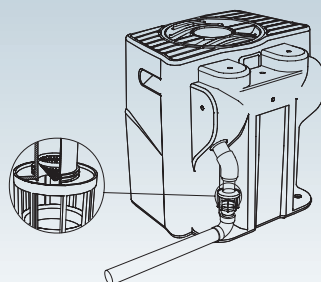

- 1 PRESS KIT
- 2 o1 KIT
- 3 Pressure gauge
- 4 Pump
- 5 Drain connection
- 6 Emptying plug
- 7 Level switch
- 8 Connections
- 9 Tank cover

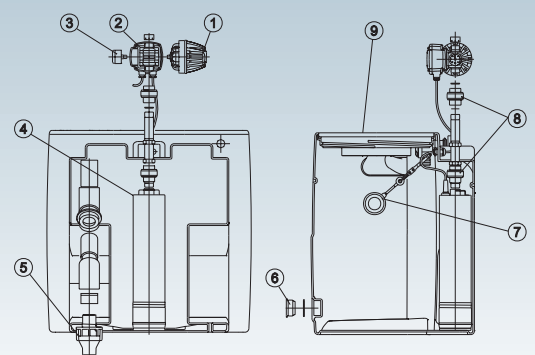

# AquaBox FEATURES

## POWER, SAFETY AND CONTROL

ACUARIA 07



TECNOPRES 15



PRISMA 15

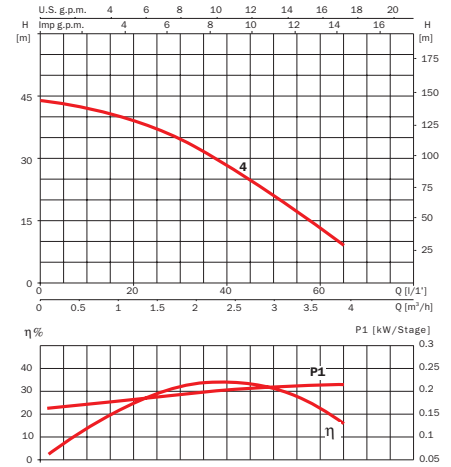
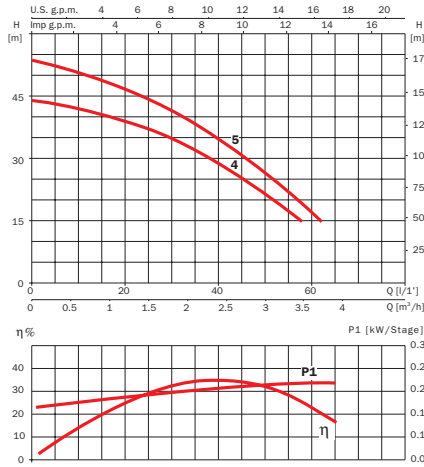
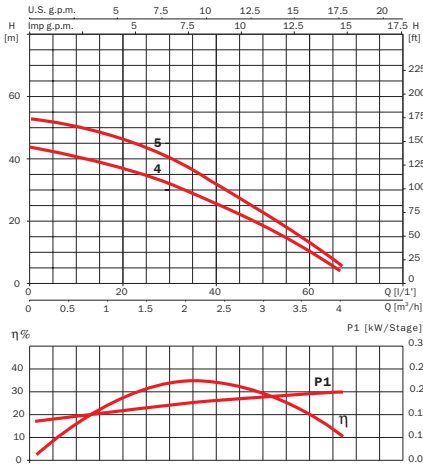

### ESPA's advanced technology gives AquaBox greater benefits:

- Storage capacity for protection against water shortages or cuts.
- Proven safety through the incorporation of protection to prevent the pump from operating without water.
- Great pumping power, at a high constant pressure.
- Good mechanical accessibility, which makes it very easy to install.
- Total control to prevent the possibility of malfunction.
- Silent. Acuaría 07: 53-54 dB. Prisma 15 and Tecnopres 15: 61-62 dB.



- A Vigilex SS
- B Clean System WG
- C DrainBox System 300
- D AquaBox System

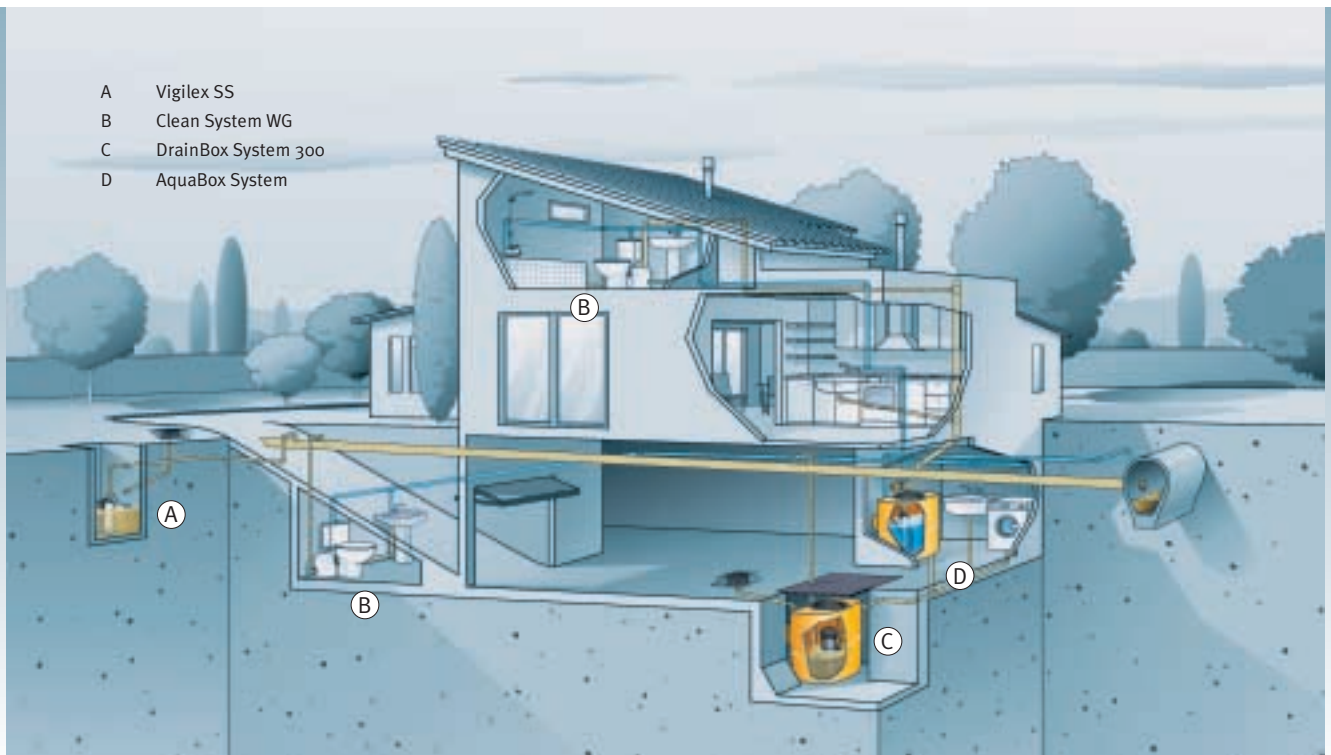

# AquaBox ... OPERATION

## SIMPLICITY AND EFFICIENCY



The AquaBox series pumping equipment is the latest-generation solution developed by ESPA to provide safety, continuity and pressure in all types of buildings located in areas where the water pressure and/or flow in the public water supply network is insufficient.

The compact design, safety, service, complete and reliable automation guarantee that AquaBox offers a high performance and great reliability.



**AquaBox** has been designed to adapt to many different sites and situations, and is the perfect solution for all users who wish to avoid or are unable to allow shortages or cuts in their water supply.

**Rural areas:** second homes, village houses, rural tourist accommodation...

**Urban areas:** detached houses, stores, restaurants...



COLLECTS  
RECIRCULATES  
PRESSURISES  
IRRIGATES  
EVACUATES  
DEPURATES  
REGENERATES  
PURIFIES

**ESPA GROUP** stands by you to provide you with  
the technology, the product, the service and the  
support you need.